

FILTERNOX OPTIMIST 312608 FILTER LAYOUT AND DIMENSIONS

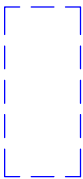

Free space for maintenance

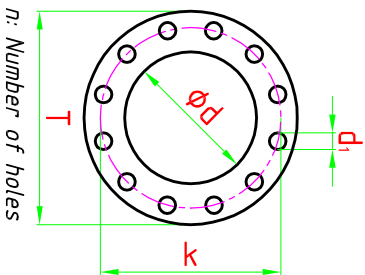

n: Number of holes

Body Material:	ALSI 304
Screen Material:	ALSI 316
Max. Operating Pressure:	10 bar
Min. Inlet Pressure Required During back-flush:	2 bar
Max. Operating Temperature:	55 °C
Pressure Loss at Max. Flow Rate:	0.2 bar
Approximate back-flush time:	20-30 sec. max.
Approximate back-flush water consumption:	150-200 l/l back-flush
Coarse Screen back-flush Outlet:	Automatic valve
Fine Screen Control System:	Hydraulic or Electrical
Coarse Screen Control System:	Timer

For high pressure, high temperature and different materials, custom made filters can be produced.

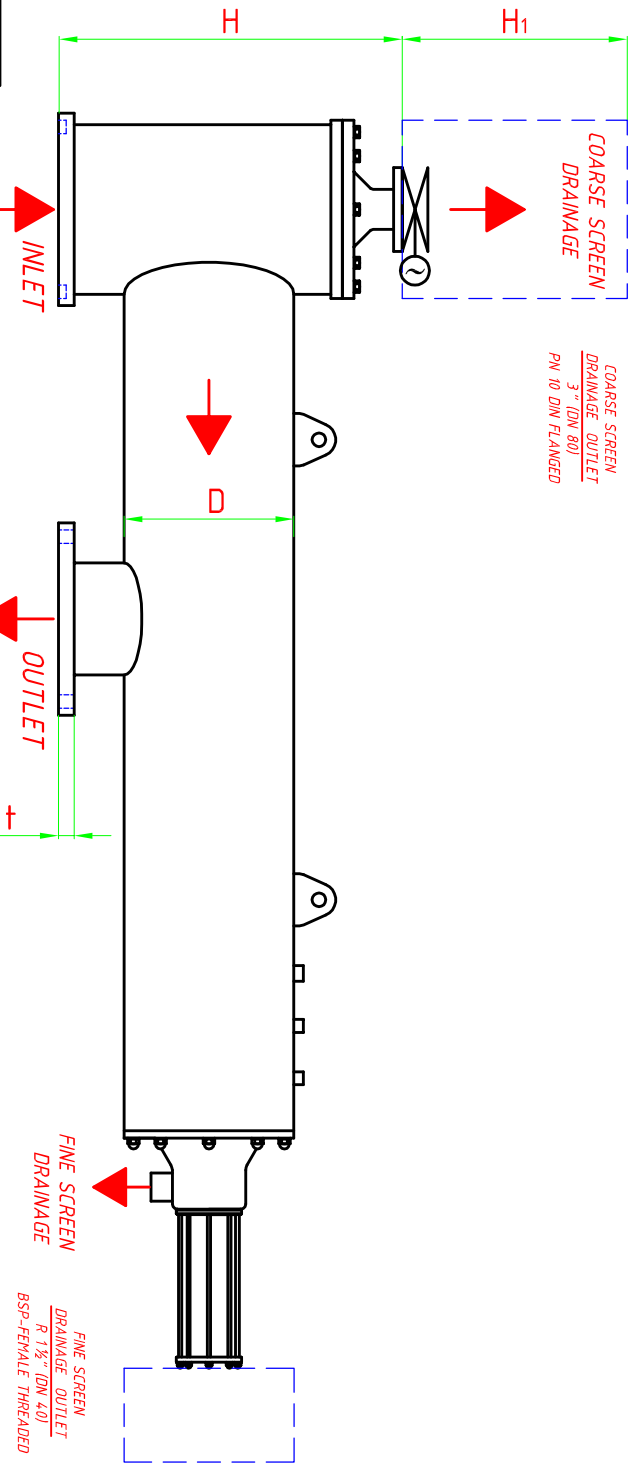

INLET/OUTLET		FLANGE SIZES ND 10 - DIN 2576						A		C		D		E		H		H ¹		L		L ¹		WEIGHT(kg)		MAX. FLOW RATE		SCREEN AREA		
inch	mm	d	T	k	d ¹	n	t																		FULL	EMPTY	m ³ /h	cm ²		
8	200	219.1	340	295	22	8	24	900	1217	12"	338	678	865	2625	1700	420	185	320												

Inlet and Coarse Screen drainage directions can be used both ways for 8" (DN 200) and wider inlet-outlet diameter. Filters. All dimensions are in millimeters.